



SOLANO COUNTY TRANSIT
UNARMED SECURITY GUARD SERVICES
SOLICITATION NO. 2019-RFP-01
ADDENDUM No. 2

ADDENDUM DATE: APRIL 2, 2019

Notice to all submitting proposals for this RFP. Addendum No. 2 is being issued for the above referenced project.

1. The following bullet point under Section 1.4 is deleted from the RFP in its entirety:
 - PROPOSERS may submit proposals for one or more areas as described in the scope of work. A separate proposal must be provided for each Scope of Work Category in which the Proposer wishes to compete.
2. Appendix D Site Plans for the SolTrans Properties is added and incorporated into the RFP and is attached here to this Addendum.

VALLEJO TRANSIT CENTER

311 SACRAMENTO ST.



- PAVING TYPE LEGEND**
- BUS AREA PAVEMENT - [Symbol] 1" CONC. 4" AG
 - PARKING LOT AC - [Symbol] 1" CONC. (TYPE A) 1" CONC. 1" AG
 - CRIB BASE/PARKING/SIDWALK - [Symbol] 1" CONC. 1" AG
 - DRIVEWAY - [Symbol] 1" CONC. 1" AG
 - STREET AC PAVEMENT - 12" AC (TYPE A) FULL DEPTH
 - STREET CONC PAVEMENT
 - LANDSCAPE (SEE LANDSCAPE PLANS)
 - LANDSCAPE (SEE LANDSCAPE PLANS)

CONSTRUCTION SET

AECOM
 200 WEST WASHINGTON AVENUE SUITE 100
 SAN FRANCISCO, CA 94111
 TEL: 415-774-2000
 FAX: 415-774-2001

APPROVED UNDER THE SUPERVISION OF:
 (SEAL) S. BARTON, REGISTERED PROFESSIONAL ENGINEER, CIVIL ENGINEER

C103

NO.	DATE	BY	DESCRIPTION

VALLEJO TRANSIT CENTER
 PAVING AREAS PLAN

CITY OF VALLEJO
 PUBLIC WORKS DEPARTMENT

APPENDIX D
 SITE PLANS FOR THE SOLTRANS PROPERTIES

CURTOLA PARK AND RIDE LOT

SO TRAN SHALL BE RESPONSIBLE FOR THE PROTECTION OF ALL UTILITIES AND SERVICES UNDERGROUND SERVICE ALERT
 Call: TOLL FREE
 1-800
 642-2444

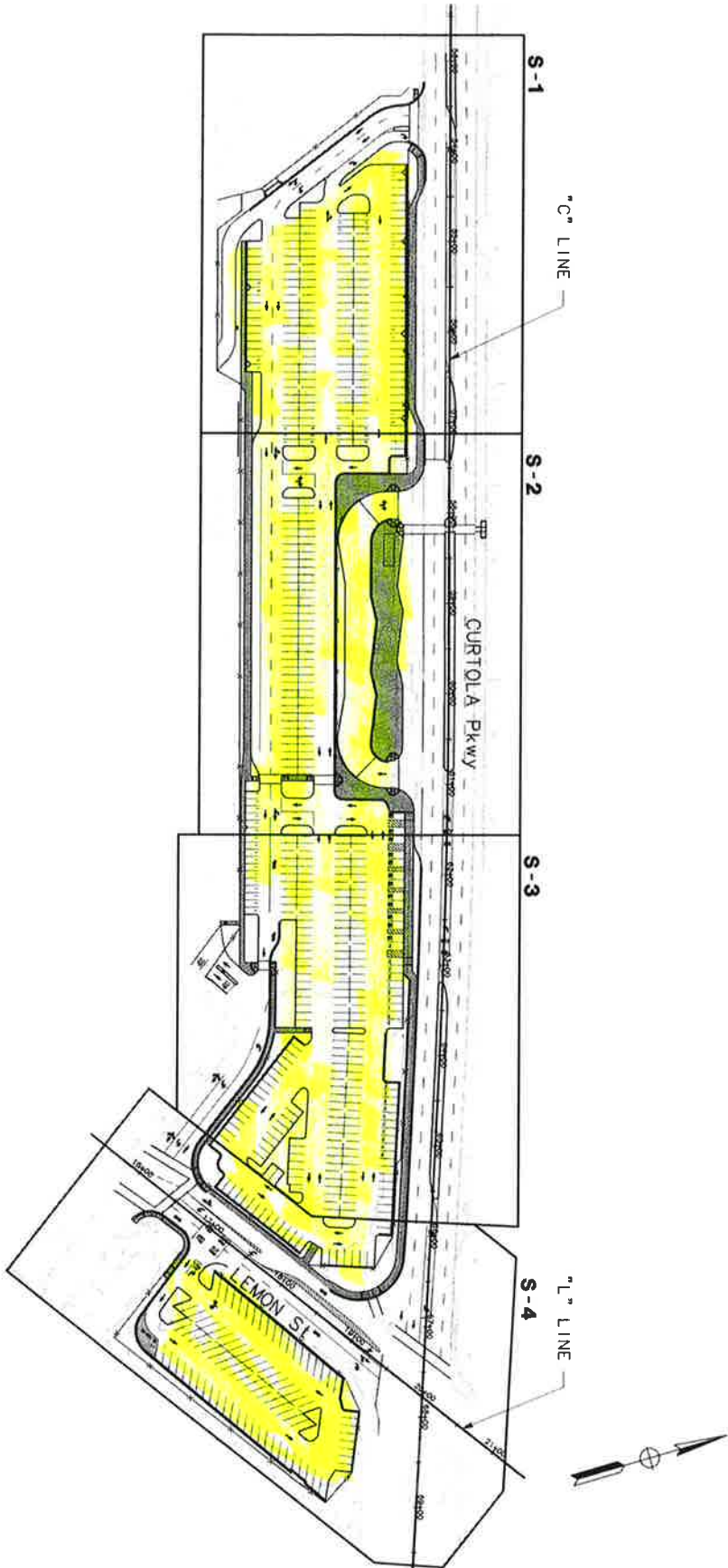

REGISTERED PROFESSIONAL ENGINEER
 STATE OF ALABAMA
 CONSULTANT CONTRACT NO. 2017-001
 RIZZO S/N/A

DATE	MARK	INITIAL

SOLTRANS CURTOLA PARK AND RIDE HUB PROJECT
 CURTOLA PARKWAY AND LEMON STREET
KEY MAP

REER THORNE & COMPANY, INC.
 10000 Highway 206, Suite 100, North
 Birmingham, AL 35243
 (205) 988-1000
 www.reerthorne.com

CONSIGNED SET
 DESIGNED BY
 AL
 DRAWN BY
 AL
 CHECKED BY
 SOK
 DATE
 5/23/14
 SHEET
 NO SCALE
 7 OF 143 SHEETS
 DRAWING TITLE

SERENO TRANSIT CENTER (OPTION)

PERSONNEL CONTROL NOTES:

1. THE CONTRACTOR IS RESPONSIBLE FOR ALL ASPECTS OF PERSONNEL CONTROL, AND FOR THE PROTECTION OF THE WORK AREA FROM UNAUTHORIZED ACCESS BY THE PUBLIC.
2. PERSONNEL CONTROL SHALL BE PROVIDED THROUGHOUT THE CONSTRUCTION PERIOD. PERSONNEL CONTROL SHALL BE PROVIDED THROUGHOUT THE CONSTRUCTION PERIOD. PERSONNEL CONTROL SHALL BE PROVIDED THROUGHOUT THE CONSTRUCTION PERIOD.
3. THE CONTRACTOR SHALL PROVIDE A DETAILED PERSONNEL CONTROL PLAN TO THE CITY ENGINEER FOR REVIEW AND APPROVAL PRIOR TO THE START OF CONSTRUCTION.
4. THE CONTRACTOR SHALL PROVIDE A DETAILED PERSONNEL CONTROL PLAN TO THE CITY ENGINEER FOR REVIEW AND APPROVAL PRIOR TO THE START OF CONSTRUCTION.
5. THE CONTRACTOR SHALL PROVIDE A DETAILED PERSONNEL CONTROL PLAN TO THE CITY ENGINEER FOR REVIEW AND APPROVAL PRIOR TO THE START OF CONSTRUCTION.
6. THE CONTRACTOR SHALL PROVIDE A DETAILED PERSONNEL CONTROL PLAN TO THE CITY ENGINEER FOR REVIEW AND APPROVAL PRIOR TO THE START OF CONSTRUCTION.
7. THE CONTRACTOR SHALL PROVIDE A DETAILED PERSONNEL CONTROL PLAN TO THE CITY ENGINEER FOR REVIEW AND APPROVAL PRIOR TO THE START OF CONSTRUCTION.
8. THE CONTRACTOR SHALL PROVIDE A DETAILED PERSONNEL CONTROL PLAN TO THE CITY ENGINEER FOR REVIEW AND APPROVAL PRIOR TO THE START OF CONSTRUCTION.
9. THE CONTRACTOR SHALL PROVIDE A DETAILED PERSONNEL CONTROL PLAN TO THE CITY ENGINEER FOR REVIEW AND APPROVAL PRIOR TO THE START OF CONSTRUCTION.
10. THE CONTRACTOR SHALL PROVIDE A DETAILED PERSONNEL CONTROL PLAN TO THE CITY ENGINEER FOR REVIEW AND APPROVAL PRIOR TO THE START OF CONSTRUCTION.



FIBER ROLL DETAIL



(UNPAVED AREAS)
INLET PROTECTION DETAIL 1



(PAVED AREAS)
INLET PROTECTION DETAIL 2

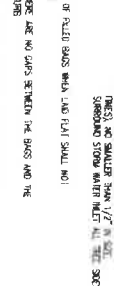

CONSTRUCTION ENTRANCE DETAIL

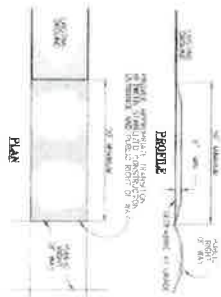

NOTES:

1. PROTECT ALL EXISTING UTILITIES AND STRUCTURES.
2. PROTECT ALL EXISTING TREES AND LANDSCAPING.
3. PROTECT ALL EXISTING CURBS AND GRATES.
4. PROTECT ALL EXISTING SIDEWALKS AND DRIVEWAYS.
5. PROTECT ALL EXISTING DRIVEWAYS AND PATHS.
6. PROTECT ALL EXISTING FENCES AND WALLS.
7. PROTECT ALL EXISTING SIGNAGE AND MARKINGS.
8. PROTECT ALL EXISTING LIGHTING AND ELECTRICAL SYSTEMS.
9. PROTECT ALL EXISTING WATER AND SEWER SYSTEMS.
10. PROTECT ALL EXISTING GAS AND OIL SYSTEMS.

CONSTRUCTION SPECIFICATIONS:

1. ALL CONSTRUCTION SHALL BE IN ACCORDANCE WITH THE CITY ENGINEER'S SPECIFICATIONS.
2. ALL CONSTRUCTION SHALL BE IN ACCORDANCE WITH THE CITY ENGINEER'S SPECIFICATIONS.
3. ALL CONSTRUCTION SHALL BE IN ACCORDANCE WITH THE CITY ENGINEER'S SPECIFICATIONS.
4. ALL CONSTRUCTION SHALL BE IN ACCORDANCE WITH THE CITY ENGINEER'S SPECIFICATIONS.
5. ALL CONSTRUCTION SHALL BE IN ACCORDANCE WITH THE CITY ENGINEER'S SPECIFICATIONS.
6. ALL CONSTRUCTION SHALL BE IN ACCORDANCE WITH THE CITY ENGINEER'S SPECIFICATIONS.
7. ALL CONSTRUCTION SHALL BE IN ACCORDANCE WITH THE CITY ENGINEER'S SPECIFICATIONS.
8. ALL CONSTRUCTION SHALL BE IN ACCORDANCE WITH THE CITY ENGINEER'S SPECIFICATIONS.
9. ALL CONSTRUCTION SHALL BE IN ACCORDANCE WITH THE CITY ENGINEER'S SPECIFICATIONS.
10. ALL CONSTRUCTION SHALL BE IN ACCORDANCE WITH THE CITY ENGINEER'S SPECIFICATIONS.

DATE	REVISION	BY	CHK
1/20/00	1
2/15/00	2
3/10/00	3
4/05/00	4
5/01/00	5
6/01/00	6
7/01/00	7
8/01/00	8
9/01/00	9
10/01/00	10
11/01/00	11
12/01/00	12



Lark and Associates
Civil Engineering
1400 S. Bascom Avenue
Suite 288
San Jose, CA 95128
Phone: (408) 552-1981
Fax: (408) 552-1985
Email: info@larkandassociates.com

Civil Engineering
Lark and Associates
1400 S. Bascom Avenue
Suite 288
San Jose, CA 95128
Phone: (408) 552-1981
Fax: (408) 552-1985
Email: info@larkandassociates.com

CITY OF VALEJO

TRANSIT VILLAGE
EROSION PLAN
TRANSPORT HILLMAN
SOLANO

CALIFORNIA

SHEET
C-7
21014-10

1850 BROADWAY (OPTION)

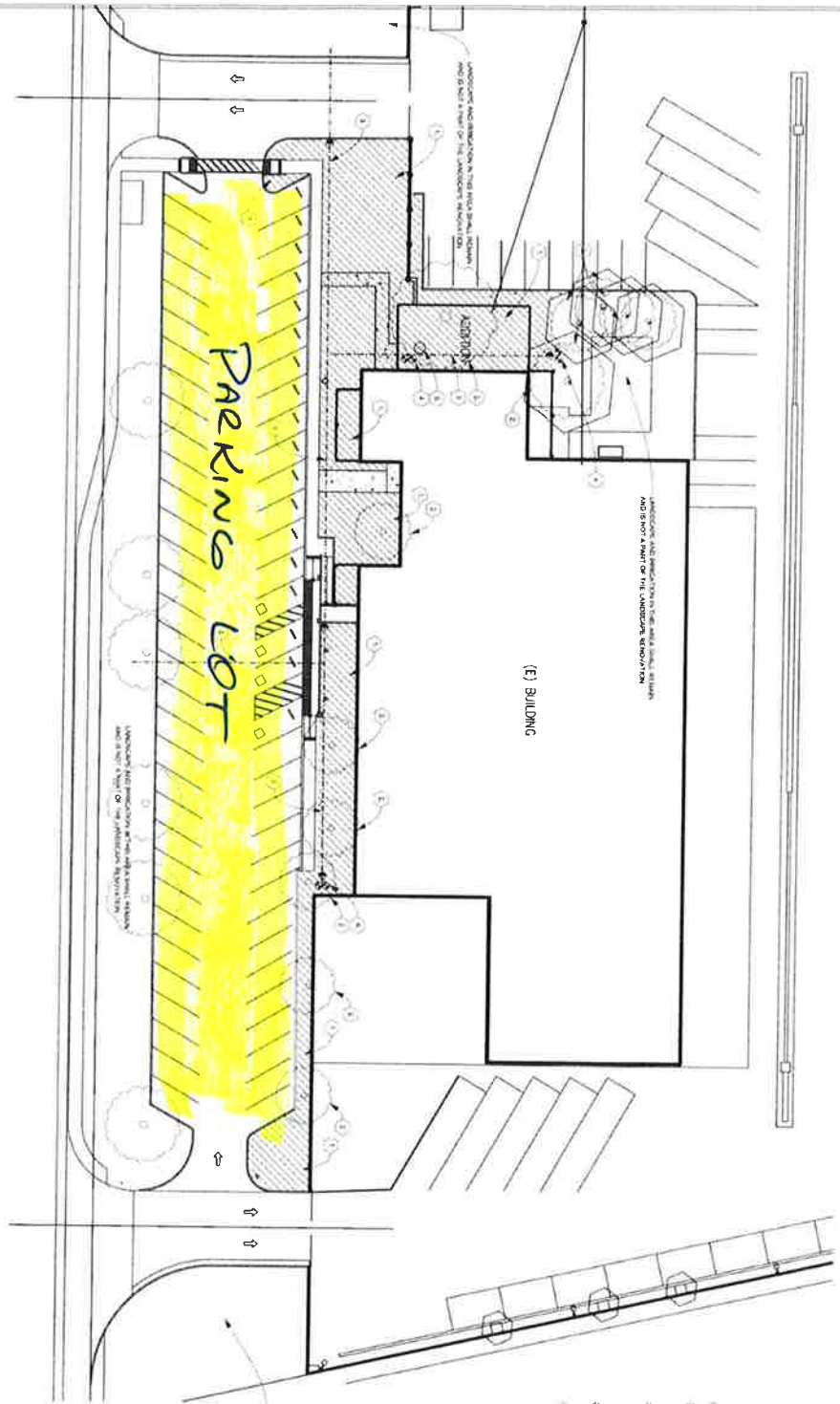

DEMOLITION NOTES

- 1) DEMOLITION OF ALL EXISTING STRUCTURES AND UTILITIES SHALL BE COMPLETED AND REMOVED FROM THE SITE.
- 2) ALL EXISTING UTILITIES SHALL BE IDENTIFIED AND PROTECTED. ANY UTILITIES TO BE REMOVED SHALL BE IDENTIFIED AND PROTECTED PRIOR TO DEMOLITION.
- 3) ALL EXISTING UTILITIES SHALL BE IDENTIFIED AND PROTECTED. ANY UTILITIES TO BE REMOVED SHALL BE IDENTIFIED AND PROTECTED PRIOR TO DEMOLITION.
- 4) ALL EXISTING UTILITIES SHALL BE IDENTIFIED AND PROTECTED. ANY UTILITIES TO BE REMOVED SHALL BE IDENTIFIED AND PROTECTED PRIOR TO DEMOLITION.
- 5) ALL EXISTING UTILITIES SHALL BE IDENTIFIED AND PROTECTED. ANY UTILITIES TO BE REMOVED SHALL BE IDENTIFIED AND PROTECTED PRIOR TO DEMOLITION.

LANDSCAPE AND REMEDIATION TO BE DONE WITHIN AND BEYOND A PART OF THE LANDSCAPE IMPROVEMENT

LANDSCAPE AND REMEDIATION TO BE DONE WITHIN AND BEYOND A PART OF THE LANDSCAPE IMPROVEMENT

SCALE: 1/8" = 1'-0"



L11

1850 BROADWAY
 VALLEJO, CALIFORNIA
 SOLANO COUNTY TRANSIT

SOLANO COUNTY TRANSIT
 OPERATIONS AND MAINTENANCE
 FACILITY IMPROVEMENT PROJECT
 LANDSCAPE DEMOLITION PLAN

A VISUAL ADVANTAGE
 Landscape Architecture Consulting Group
 6882 Highland Road
 Granite Bay, CA 95746
 Phone: (916) 791 - 6300

